

Sanitary, Non-Metallic Ball Valves

Developed specifically for bio-pharmaceutical process environments.

TBL Performance Plastics offers manually operated, sanitary Ball Valves in Natural Polypropylene and PVDF (Kynar). Wetted seats are manufactured from virgin grade FEP. Seals are available in EPDM or Silicone.

Features

- Medical Grade Materials
- Animal Derivative Component Free (ADCF)
- Uninterrupted Flow Path
- 1/4 Turn Handle
- USP Class VI <88>
- Different Seal Options
- Gamma Stable

Available Sizes

Mini, 1", 1-1/2" and 2" (Sanitary)

Body Materials

- Polypropylene
- PVDF (Kynar®)

Seal Materials

- EPDM
- Patinum Cured Silicone



Kynar® is a ARKEMA Registered Trademark

Sanitary, Non-Metallic Ball Valves

Developed specifically for bio-pharmaceutical process environments.

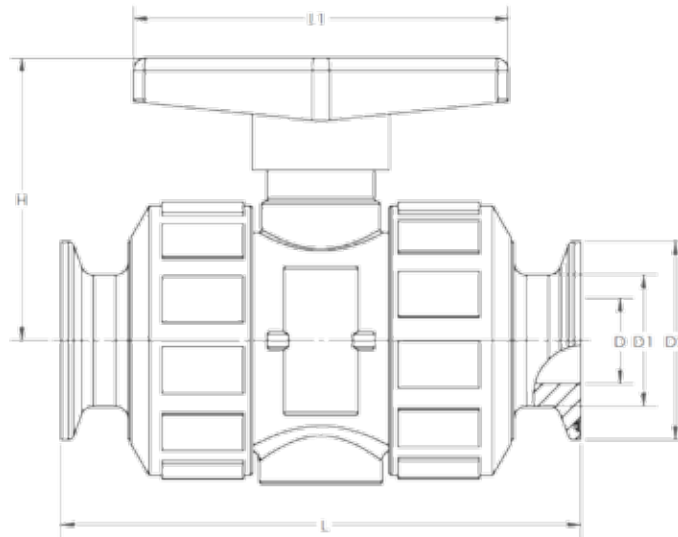

Part Number	L	L1	H	D	D1	D2
BV-M-075**.*	4.75" (120.10MM)	3.15" (80MM)	1.90" (48MM)	.560" (14.20MM)	.75" (19.10MM)	.992" (25.20MM)
BV-M-100M**.*	5.20" (123.40MM)	3.75" (95.30MM)	2.65" (67MM)	.856" (21.70MM)	1.106" (28.10MM)	1.50" (38.10MM)
BV-M-100L**.*	5.80" (147.30MM)	3.75" (95.30MM)	2.65" (67MM)	.856" (21.70MM)	1.315" (33.40MM)	1.984" (50.40MM)
BV-M-150**.*	7.25" (185MM)	4.50" (115MM)	3.50" (90MM)	1.356" (34.5MM)	1.606" (40.80MM)	1.984" (50.40MM)
BV-M-200**.*	7.25" (185MM)	4.50" (115MM)	3.50" (90MM)	1.856" (47.10MM)	2.106" (53.50MM)	2.516" (63.90MM)

Ordering Example: **BV-M-150PP-E**

Ordering Example BV-M-150PP-E

BV=Ball Valve

M=Manual

075= Mini Sanitary Connection

100= 1" Sanitary Connection

150= 1-1/2" Sanitary Connection

200= 2" Sanitary Connection

PP=Polypropylene

K=PVDF (KYNAR®)

E=EPDM

S= Silicone

Available with flush tank weld



Related Product



Made in the USA